

ISEO Air Distribution



GRLFX

Linear bar grille in anodised aluminium, finished RAL9010, with a simple row of fixed winglets (15° deflection), for wall mounting.

Model	GRLFX 200x100	GRLFX 300x100
Code	000776	000777
Width	200	300
Height	100	100

Dimensions in mm



GRLFOR

Architectural rectangular perforated grille in galvanised steel, finished RAL9010, to ornament walls.

Model	GRLFOR 200x100	GRLFOR 300x100
Code	000778	000779
Width	200	300
Height	100	100

Dimensions in mm



PLMLS 200X100 1x75

Plenum in galvanised steel for air exhaust/supply, with adjustable shutter, for architectural rectangular grille - 1 long side outlet Ø80mm (suitable for semi-rigid duct CNDFLB 75/63).

Model	PLMLS 200x100 1x75
Code	000739

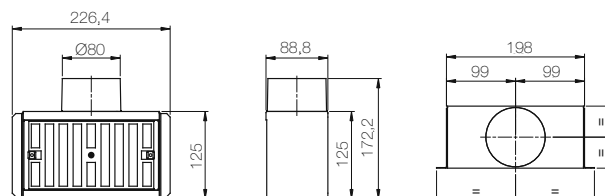
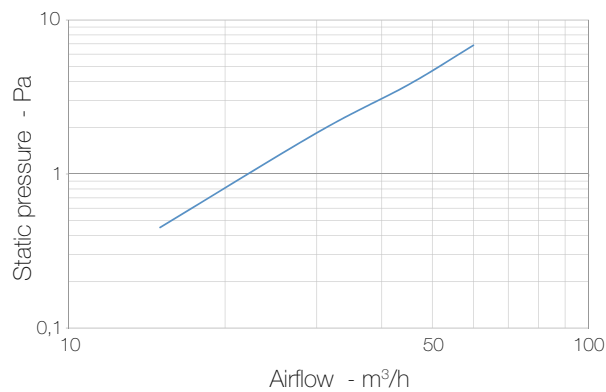

Dimensions in mm

ISEO Air Distribution



PLMLS 300x100 2x75

Plenum in galvanised steel for air exhaust/supply, with adjustable shutter, for architectural rectangular grille - 2 long side outlet Ø80mm (suitable for semi-rigid duct CNDFLB 75/63).

Model	PLMLS 300x100 2x75
Code	000740

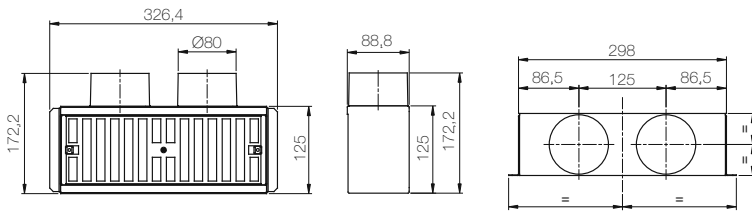

Dimensions in mm

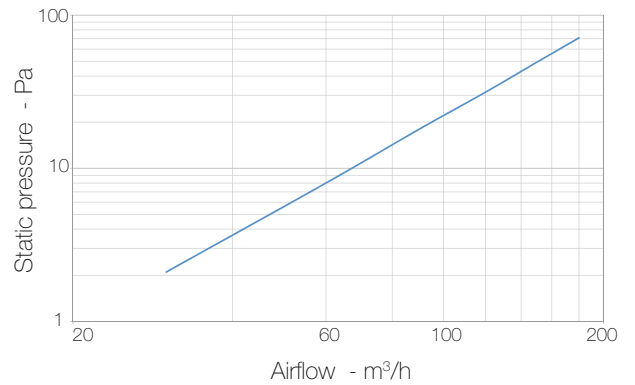

PLMPS 200x100 1x75

Plenum in galvanised steel for air exhaust/supply, with adjustable shutter, for architectural rectangular grille - 1 rear outlet Ø80mm (suitable for semi-rigid duct CNDFLB 75/63).

Model	PLMPS 200x100 1x75
Code	000769

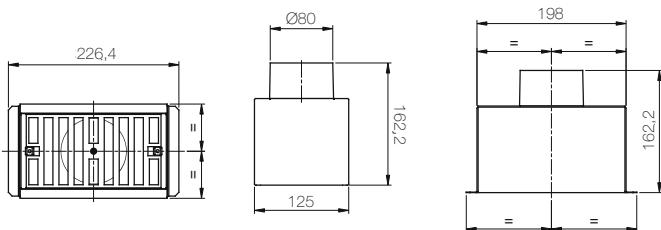

Dimensions in mm

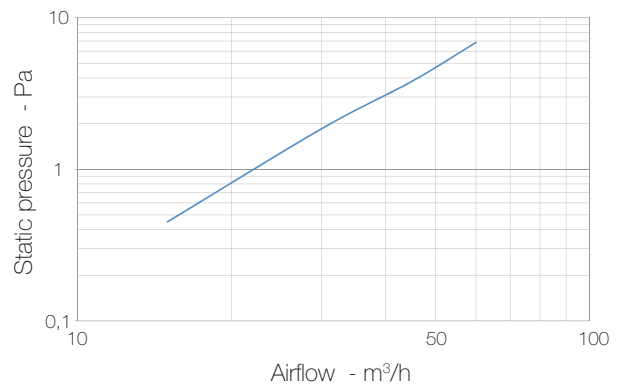

ISEO Air Distribution



PLMPS 300x100 2x75

Plenum in galvanised steel for air exhaust/supply, with adjustable shutter, for architectural rectangular grille - 2 rear outlet Ø80mm (suitable for semi-rigid duct CNDFLB 75/63).

Model	PLMPS 300x100 2x75
Code	000770

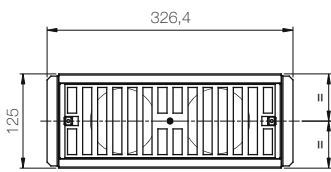

Dimensions in mm

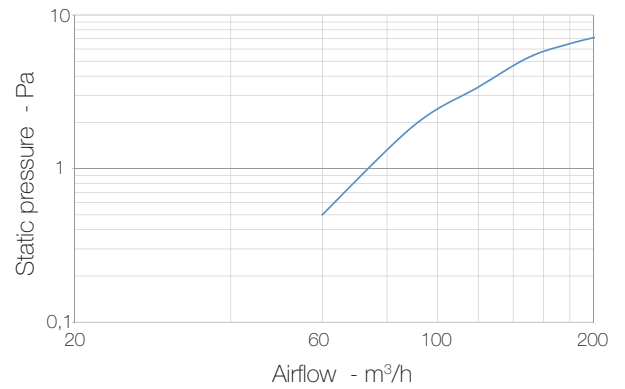
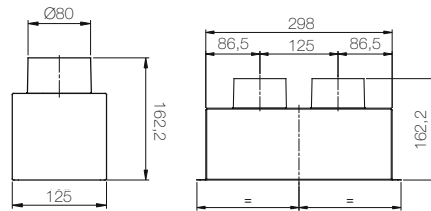

PLMPS 300x100 1x90

Plenum in galvanised steel for air exhaust/supply, with adjustable shutter, for architectural rectangular grille - 1 rear outlet Ø100mm (suitable for semi-rigid duct CNDFLB 90/75).

Model	PLMPS 300x100 1x90
Code	001547

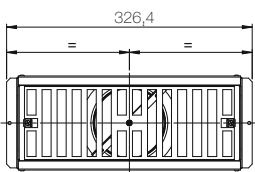

Dimensions in mm

